

9

Take out latch (2), the two springs (8) and the two pins (9) (Fig 9).

Pay attention as parts may jump out.

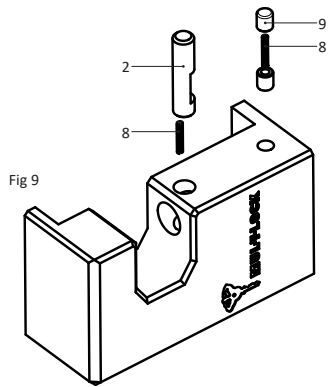

10

Pull out the cylinder (11) together with the cylinder holder (5). Pull out the activator (4).

Take out the cylinder (11) from cylinder holder (5).

**Note:** Pay attention to shutter (6) and spring (7).

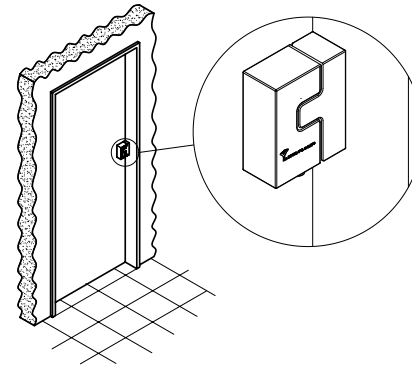
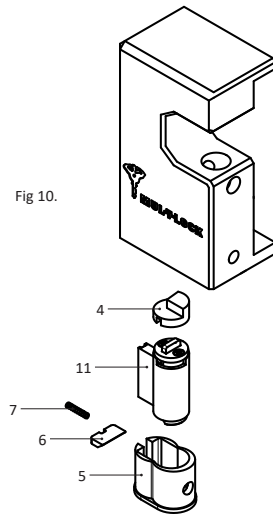

[www.mul-t-lock.com](http://www.mul-t-lock.com)

The Mul-T-lock name and Muscleman Logo, and any other name, mark or logo used by Mul-T-Lock and marked by ® or ™ sign, are registered/pending trademarks of Mul-T-Lock Ltd. in various countries. Mul-T-Lock reserves the right to make any product improvements or modifications without prior notice.

© 2018 Mul-T-Lock Technologies Ltd. Cat. No.28500290-B

An ASSAABLOY Group brand

**ASSA ABLOY**

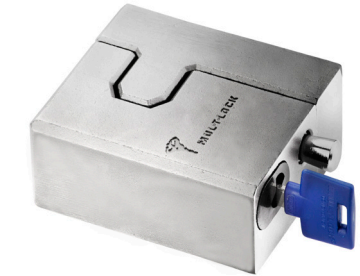

# HaspLock DIAMOND

## Installation and Service Instructions



11

At this stage it is possible to re-key the cylinder (11). Reassemble the new pins according to the new combination. Check for proper shear line with the new key.

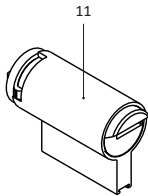

Assemble shutter (6) and shutter spring (7) into cylinder holder.

Insert the cylinder (11) into cylinder holder (5).

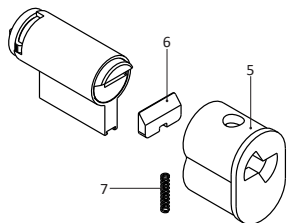

12

Insert latch (2) and spring (8) into lock body.

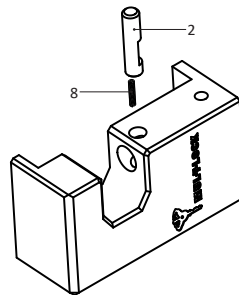

- Insert activator (4) into lock body.
- Insert the cylinder (11) together with the cylinder holder (5).

**Note:** Press latch (2) to verify engagement of the activator.

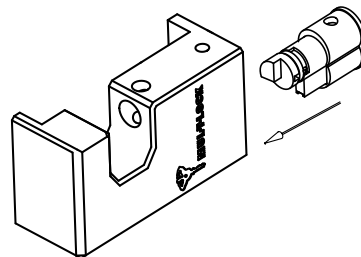

13

Insert the pins (9) and spring (8). Press and hold stopper pin. While pressing insert operating key and verify proper operation of the lock.

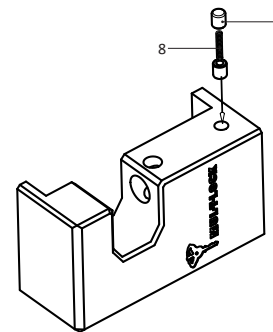

14

While pressing the pin (9) push the bolt (3) in. After assembled verify proper operation of the lock.

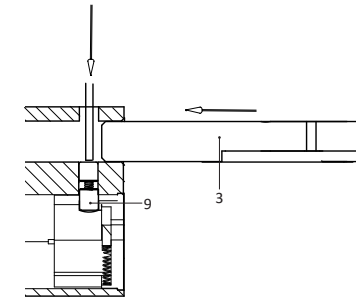

1

**Installation with screws**

Mark position of fixing screws (Fig 1).

Drill holes for M8 screws.

Allow a gap of 2 mm between lock parts.

Screws position can be slightly adjusted according to installation.

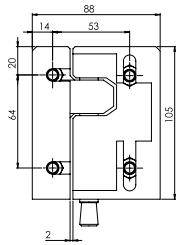

Fig 1

HaspLock DIAMOND position for double swing door or sliding door (Fig 2).

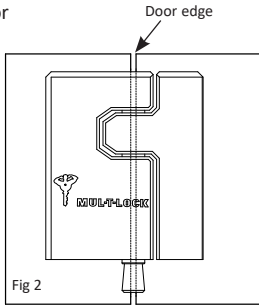

Fig 2

5

**Welding adaptor kit - P/N 28500291**

The kit includes:

- 2 Metal welding adaptors
- 4 nuts M8 DIN 934 or DIN 439
- 4 socket head screws M8X16

Assemble the welding adaptors to the HaspLock Diamond using 4 nuts and screws.

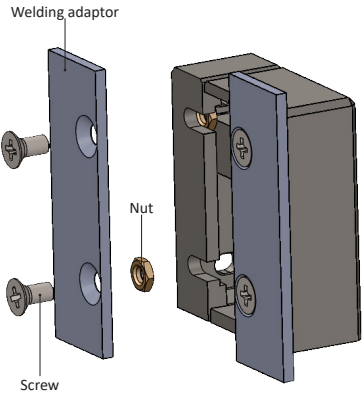

2

Place the HaspLock DIAMOND on the door. Slightly fasten M8 fixing screws with screw nuts (Fig 3).

**Note:** Check that the door can be opened and closed properly before complete tightening of the screws.

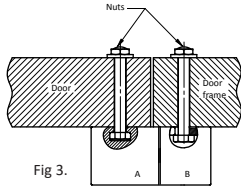

Fig 3.

When using side screws, drill through holes in the frame, mount the screws and secure with nuts (Fig 4).

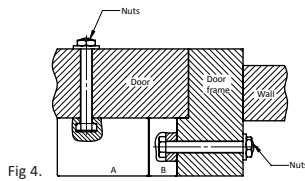

Fig 4.

**Note:** Rivet or weld the nuts in order to protect from unauthorized disassembling.

6

**Follow welding process described in para. 3-4.**

Use steel electrodes to weld the metal welding adaptors.

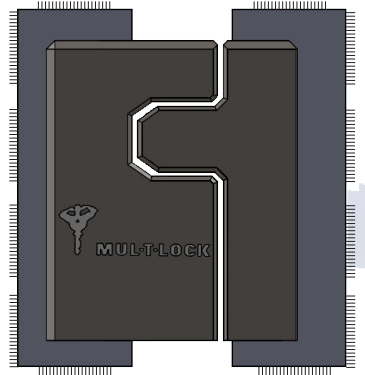

3

**Installation by welding**

**Warning:**

**To avoid any damage to the cylinder and mechanism remove them from HaspLock DIAMOND housing prior to the welding process.**

**See cylinder removal process on para. 6-8.**

Clean surface to be welded from paint/dirt/grease etc. Insert the supplied spacer between the two parts (Fig 5). Hold the two parts and Insert the locking bolt to ensure proper alignment of the parts. Take the bolt out.

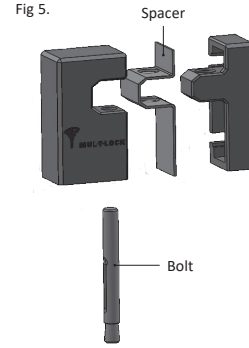
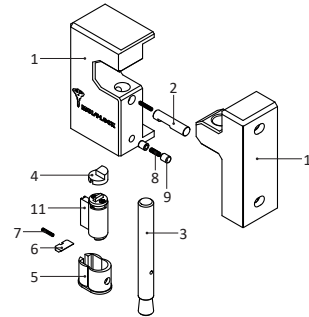

Fig 5.

7

**General view**



No.	Description	P/N
1	Body 1 for HaspLock DIAMOND	28500261
2	Latch for HaspLock DIAMOND	28500266
3	Bolt for HaspLock DIAMOND	28500262
4	Activator	28500263
5	Cylinder holder	28500146
6	Shutter	28500144
7	Spring for slider	28200150
8	Spring for latch	28500207
9	Pin	28500267
10	Counter body	28500264
11	Cylinder	-

4

Use special steel/stainless steel electrodes to weld the HaspLock DIAMOND temporarily in few welding points. Remove the spacer. Check a free movement of the bolt inside the two parts. Check for proper operation of the door. Complete welding areas.

Seal cylinder and bolt openings and paint over the welded parts with appropriate rust-resistant paint.

**Note:** when completing assemble the cylinder and mechanism. See service chapter on Para. 11-14. Check for proper operation of the lock and the door.

**See two options:** left swing door (Fig 6) and right swing door (Fig 7).

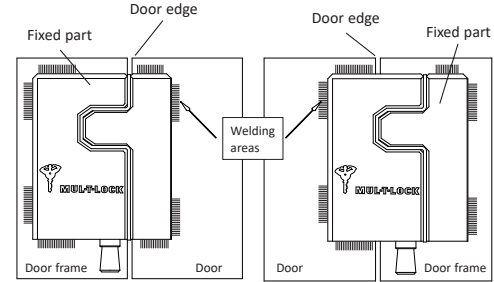

Fig 6.

Fig 7.

8

**HaspLock DIAMOND service**

Unlock padlock with operating key. Pull the bolt (Fig 8) until holes in the bolt and lock body are parallel (Fig 8a). Use a small tool to press the pins (9) and remove the bolt by pulling it out carefully.

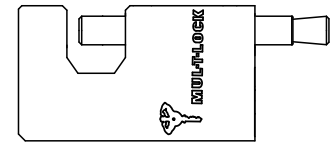

Fig 8

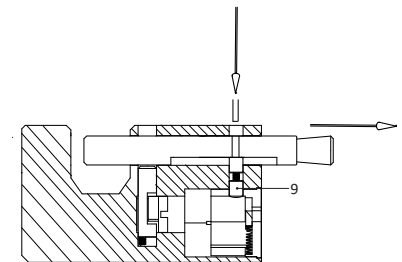

Fig 8a