



Multipoint Lock - 415G

Installation Instructions



The Mul-T-lock name and Musclemán Logo, and any other name, mark or logo used by Mul-T-Lock and marked by an ® or ™ sign, are registered/pending trademarks of Mul-T-Lock Ltd. in various countries. Mul-T-Lock reserves the right to make any product improvements or modifications without prior notice. © 2007 Mul-T-Lock Technologies Ltd. Cat. No. 26930295-E

An ASSAABLOY Group brand

ASSA ABLOY

www.mul-t-lock.com

General view

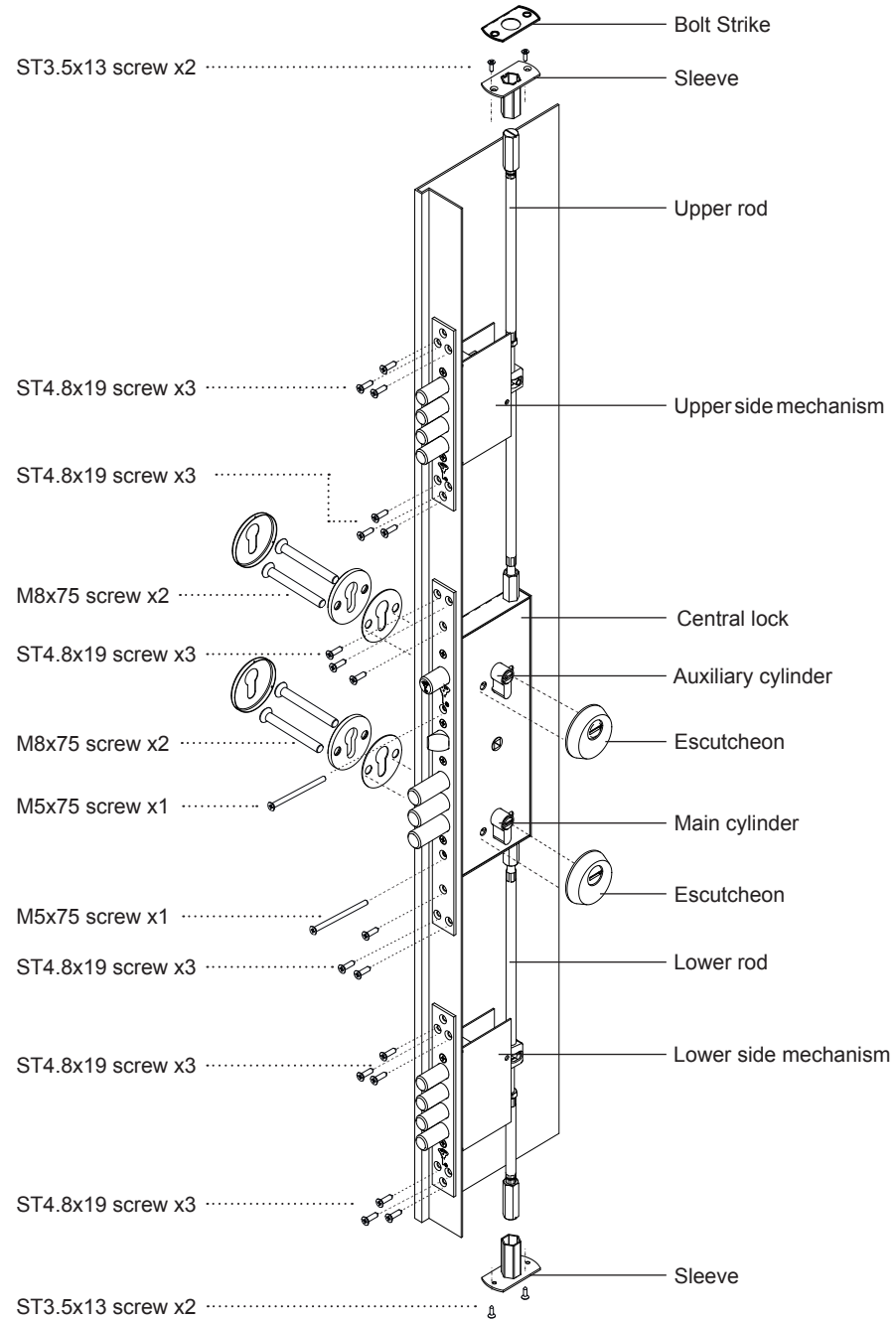
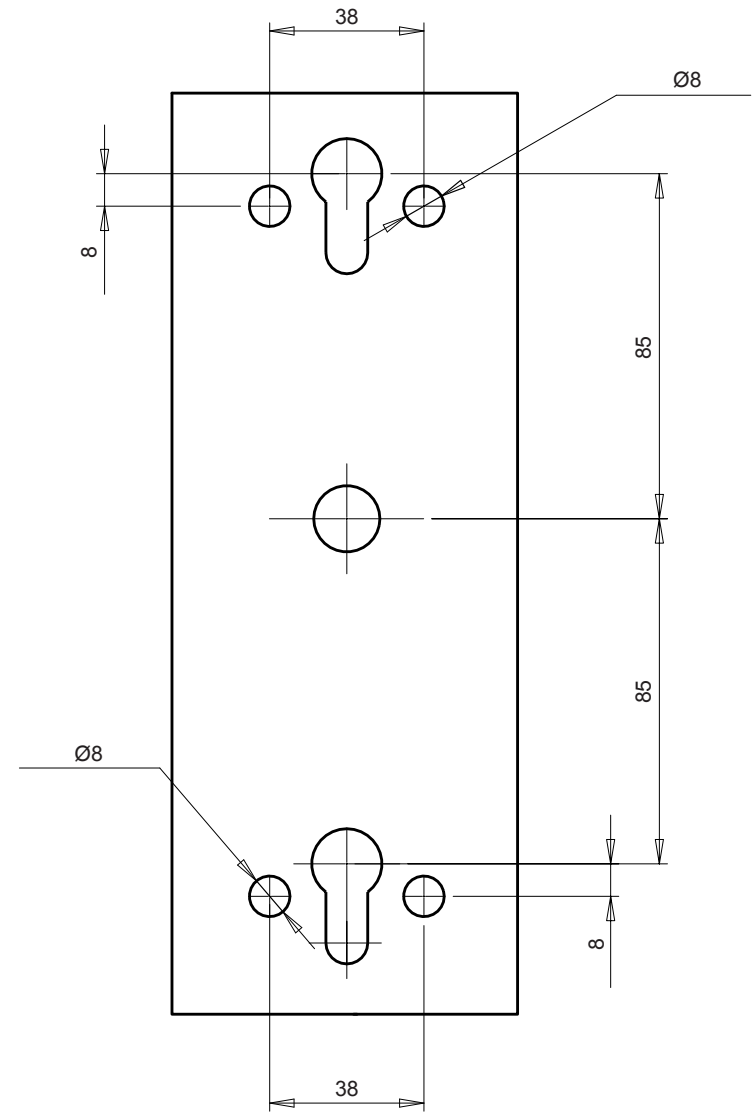

Fig. 1

Escutcheons footprint



OEM - Door manufacturer installation

Assembling and fixing lock parts into the door

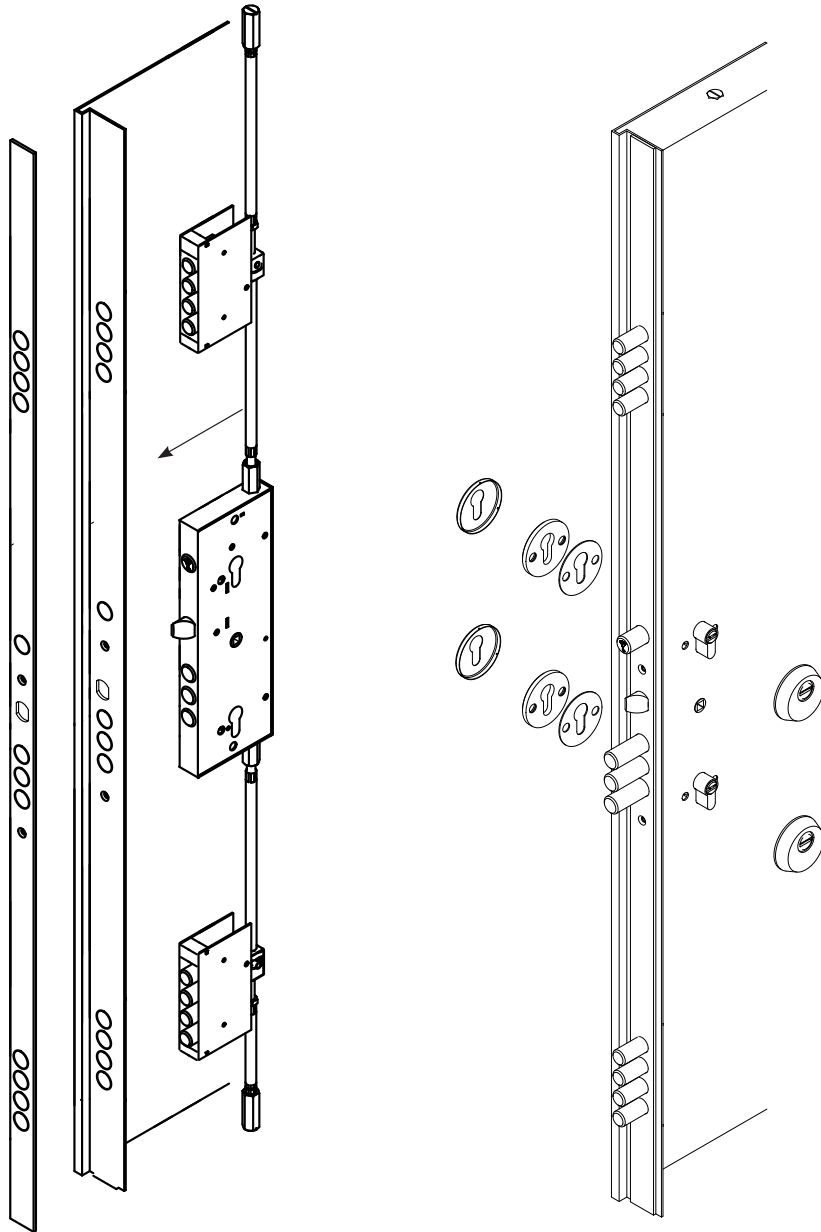

Central lock assembly

Insert central lock into the door.

Partly fasten 6 screws (ST4.8x19) to fix the central lock to the door.

Insert Euro profile cylinder (type 31x38 - cam 30°) into the main locking mechanism.

Fasten cylinder fixing screw (M5x75)

Insert Euro profile cylinder (type 31x38 - cam 30°) into the auxiliary locking mechanism.

Fasten cylinder fixing screw (M5x75)

Check both cylinders for proper operation of locking mechanisms.

Place escutcheons over main and auxiliary cylinders.

Fasten 4 screws (M8x75) from inner side of the door. Check for proper operation of both locking mechanisms.

Fasten 6 screws (ST4.8x19) of central lock. Check for proper operation of both locking mechanisms.

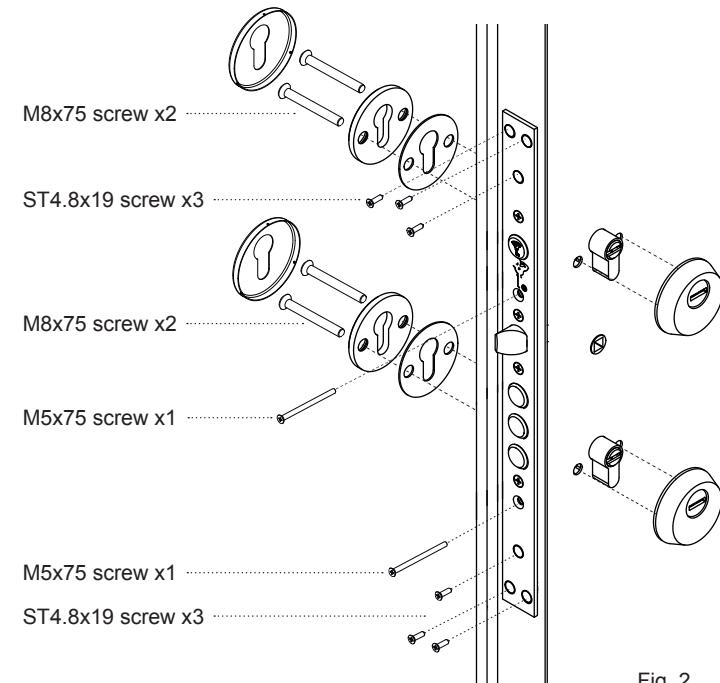

Fig. 2

Lower rod and side mechanism assembly

Adjust length of lower rod so the tip is flushed with lower edge of the door.
Fasten the nut. Insert the rod and screw it all the way into the central lock. Turn the rod counter-clock-wise approximately 6 turns.
Insert lower side mechanism.
The mechanism's back lever should fit into the connector in the lower rod (Fig. 4)
Fasten 6 screws (ST4.8x19) to fix lower side mechanism to the door.
Operate locking mechanism to verify proper operation. Make sure that the bolts are flushed with the faceplate surface in open position.
To adjust the position of the connector, rotate the rod using the lower sleeve, until the right position is achieved. Position connector perpendicular (90°) to lower side mechanism (Fig. 4), insert sleeve and fasten 2 screws (ST3.5x13)
Check for proper operation of the locking mechanism.

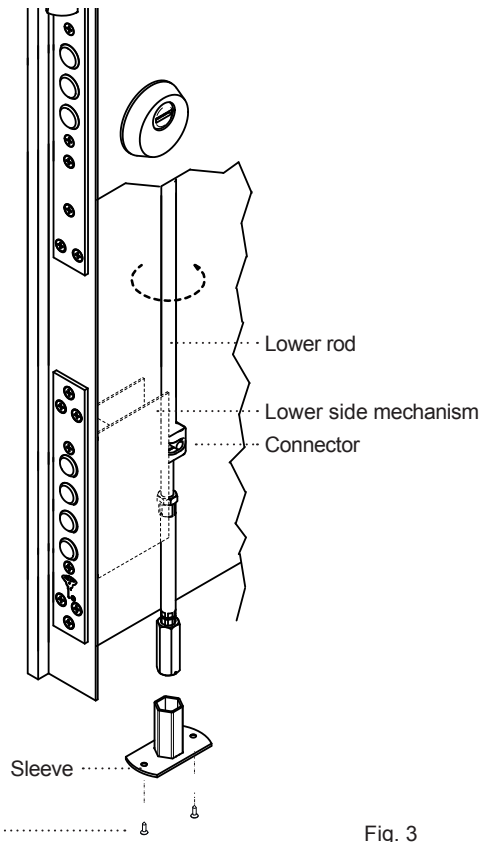

Fig. 3

Changing latch direction

Insert a screwdriver into the hole at the back of the lock and push the latch forward. Turn the latch 180° to the direction required (Fig. 8, 9, 10)

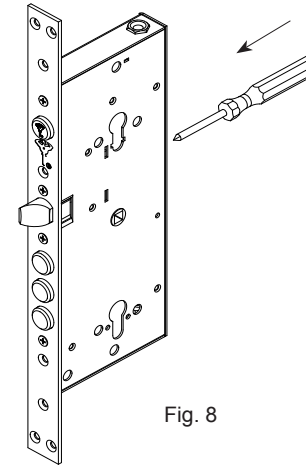

Fig. 8

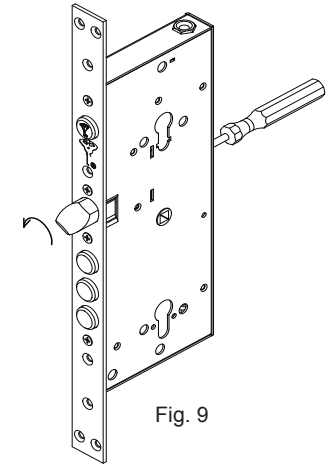

Fig. 9

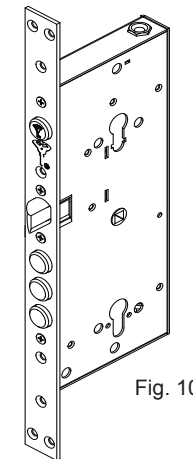

Fig. 10

Multipoint Lock 415G - Footprint

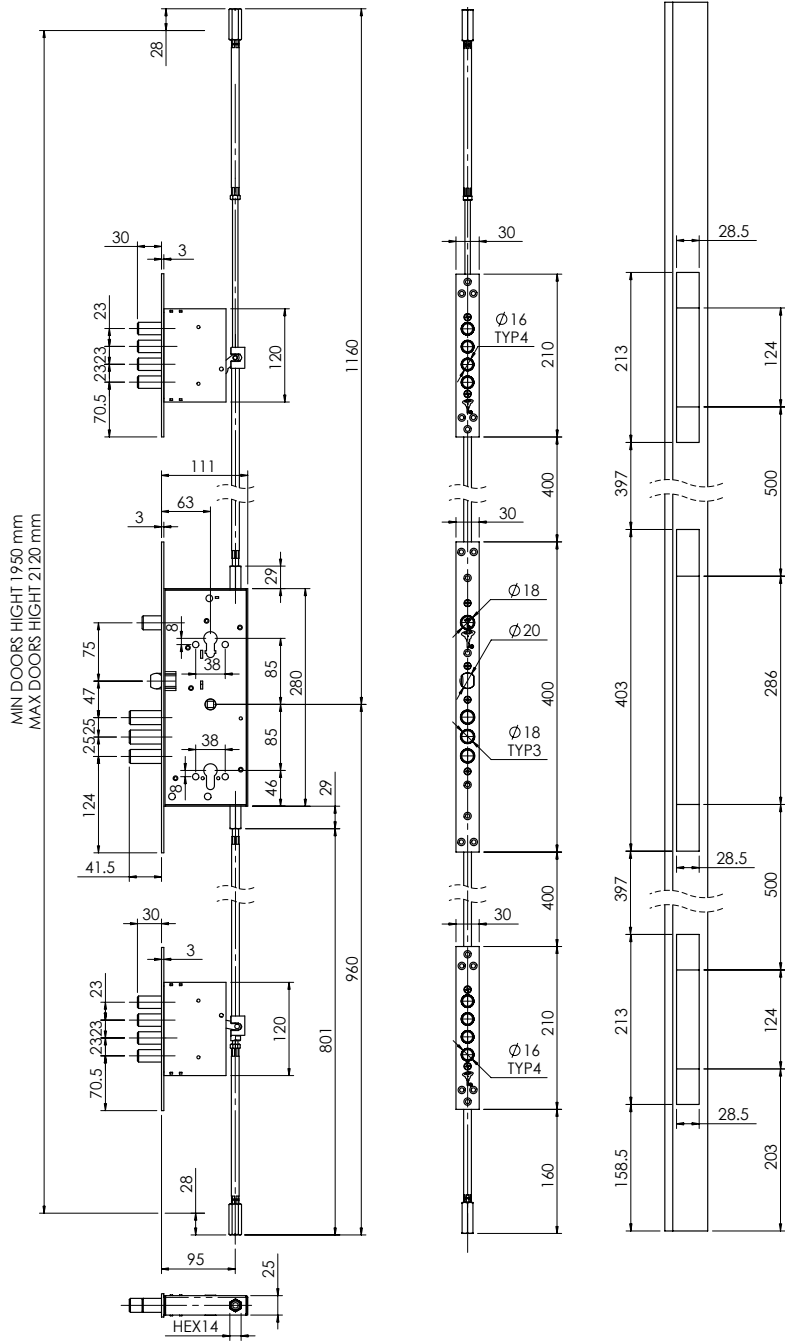

Fig. 7

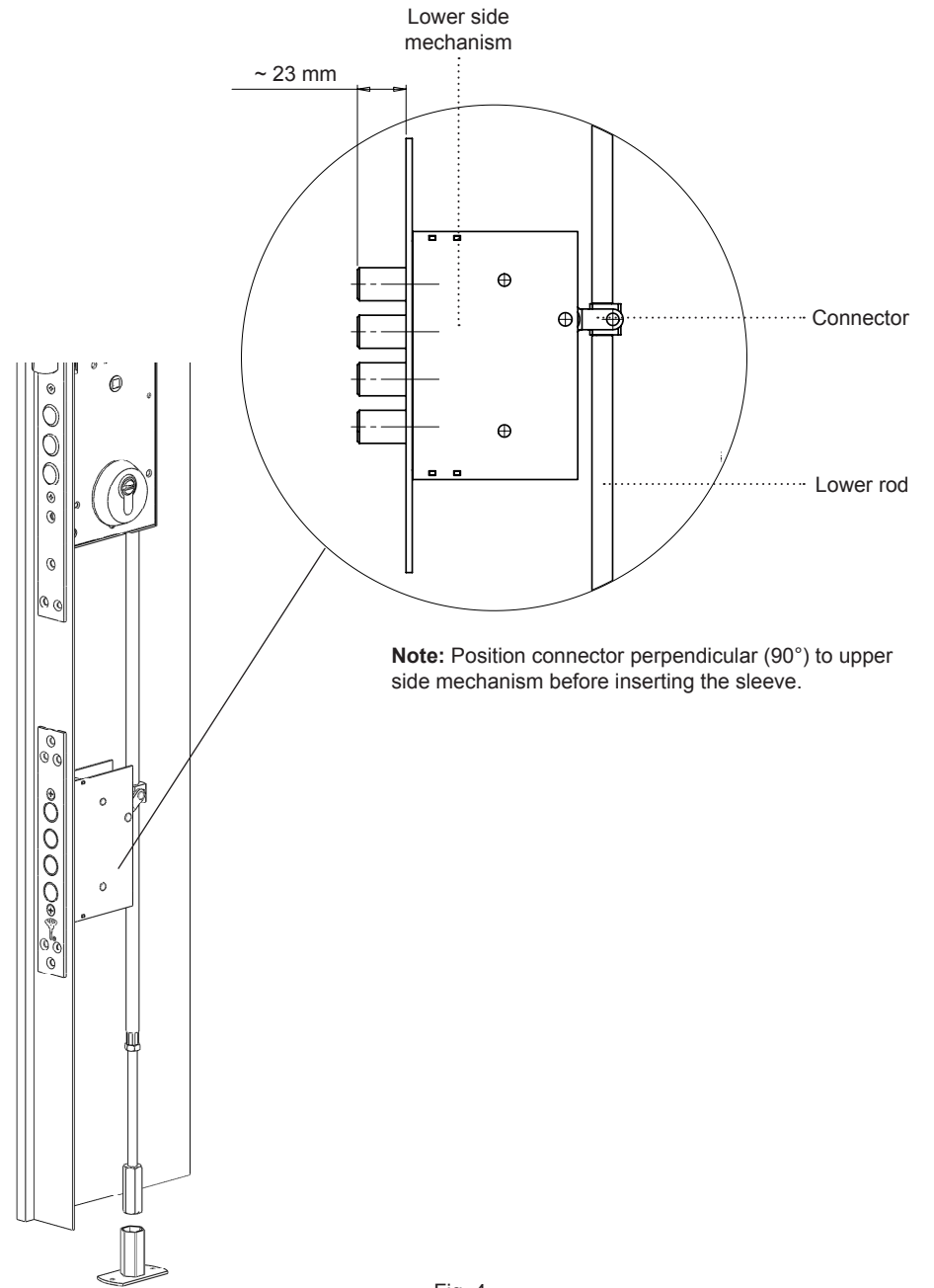

Fig. 4

Upper rod and side mechanism assembly

Adjust length of upper rod so the tip is flushed with upper edge of the door.
Fasten the nut. Insert the rod and screw it all the way into the central lock. Turn the rod counter-clock-wise approximately 6 turns.
Insert upper side mechanism.

The mechanism's back lever should fit into the connector in the upper rod (Fig. 4)
Fasten 6 screws (ST4.8x19) to fix upper side mechanism to the door.

Operate locking mechanism to verify proper operation.

Make sure that the bolts are flushed with the faceplate surface in open position.

To adjust the position of the connector, rotate the rod using the lower sleeve, until the right position is achieved. Position connector perpendicular (90°) to upper side mechanism (Fig. 4), insert sleeve and fasten 2 screws (ST3.5x13)

Check for proper operation of the locking mechanism.

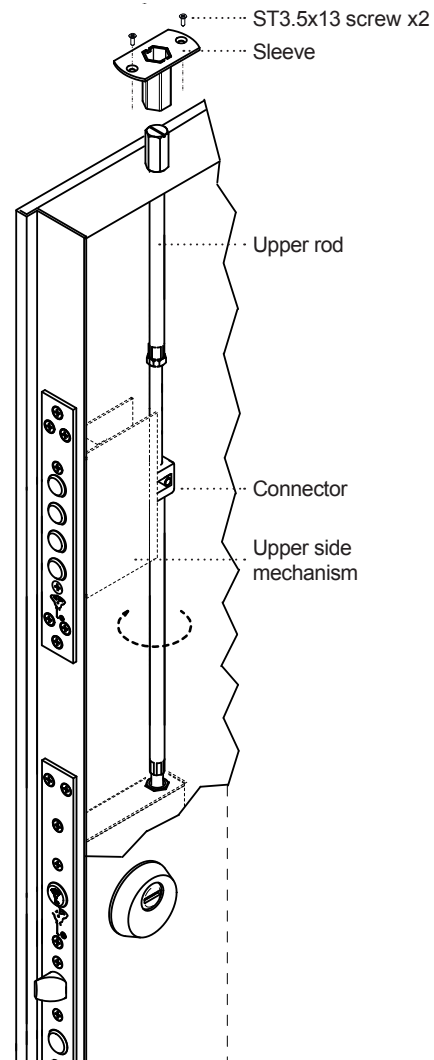

Fig. 5

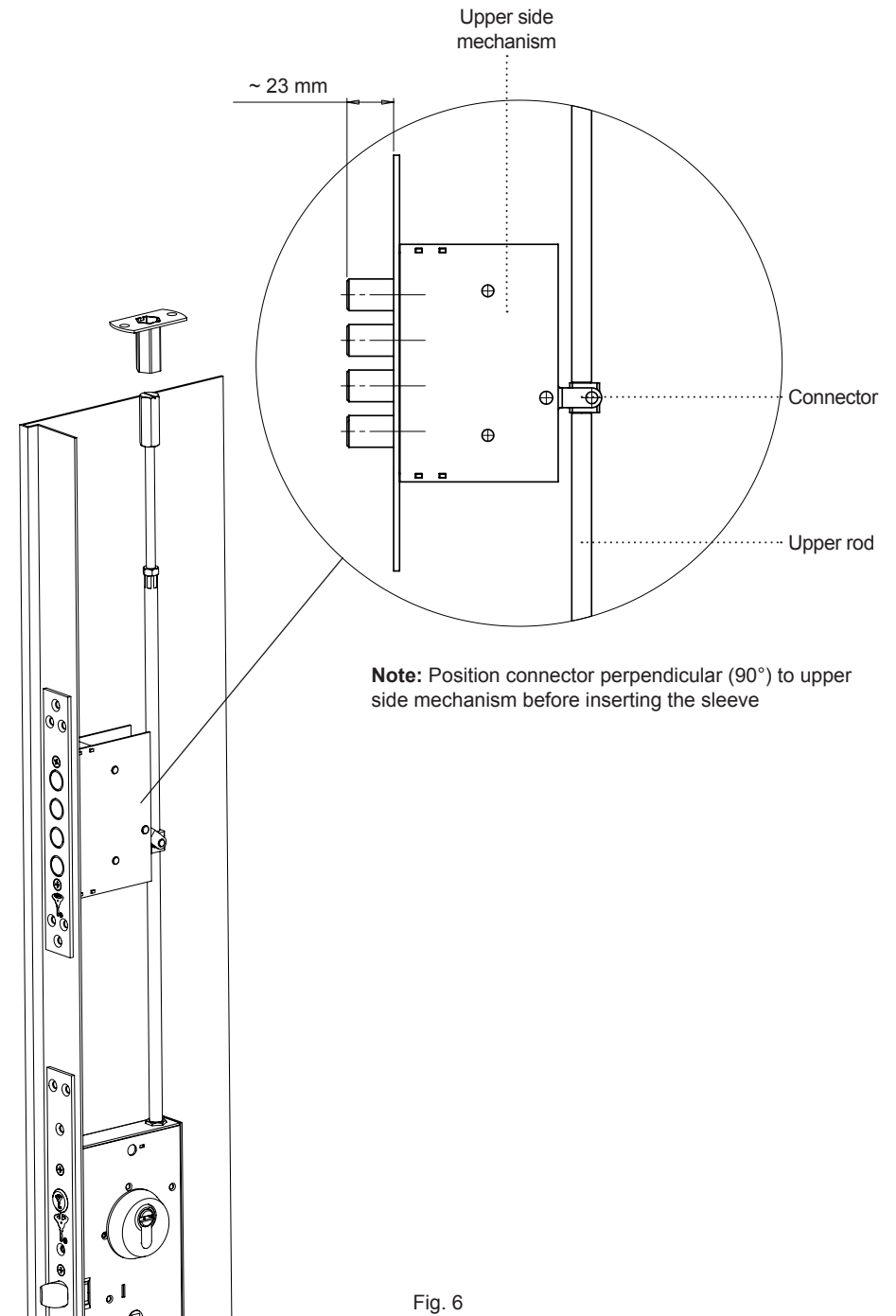

Fig. 6