



Hercular® Captive lock Instructions Manual

Dear customer,

Thank you for purchasing this high quality, High Security Mul-T-Lock product.

Hercular® is probably the best Deadbolt lock available on the market today, and now, with the Captive Key feature, it offers new convenience: the security of a double cylinder, combined with the thumb-turn friendliness of the single cylinder.

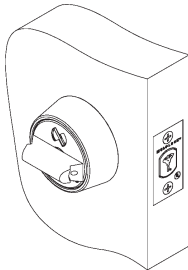

How to use your Hercular® Captive lock:

The single cylinder mode

To create the convenient thumb-turn feature, just insert the thumb-turn key into the central keyhole. Once inserted, it will remain securely in place, providing the functionality, safety and appearance of a single cylinder Deadbolt. This mode is recommended when there are people on the premises.

The double cylinder mode

Before leaving the premises, insert the regular key into the upper keyhole and turn 90°. Now the thumb-turn key may be removed (and stored safely for future use) transforming the lock into a regular double cylinder Hercular® Deadbolt. To remove the regular key, turn it back to its starting position and pull out.

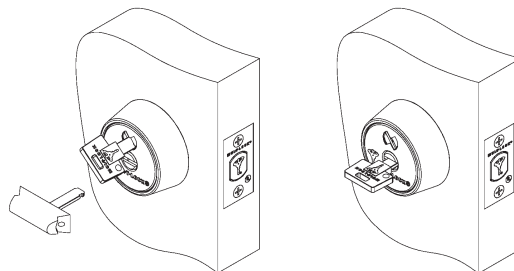

www.mul-t-lock.com

The Mul-T-Lock and the Hercular names, the muscman logo and any other name, mark or logo used by Mul-T-Lock and marked by an ® or ™ sign are registered/pending trademarks of mul-t-lock ltd. Mul-T-Lock reserves the right to make any product improvements or modifications without prior notice. ©2007 Mul-T-Lock Technologies Ltd. Cat. No. 22900380-C

An ASSA ABLOY Group brand

ASSA ABLOY