

HERCULAR®

2 3/8" to 2 3/4" backset conversion instructions

- 1- Throw the bolt into locked position.
 - Depress the pin to release the bolt mechanism from the bolt housing.

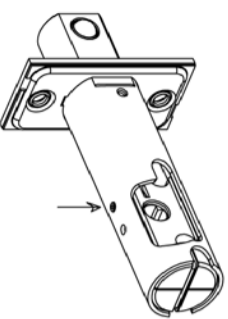

- 2- Carefully slide the mechanism through the back side bolt housing.

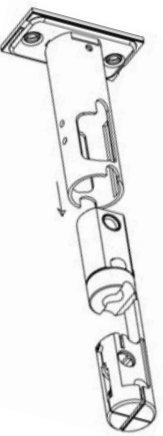

1

3 Install bolt (Standard type)

- Install bolt as shown in diagram.
- Fasten with screws.

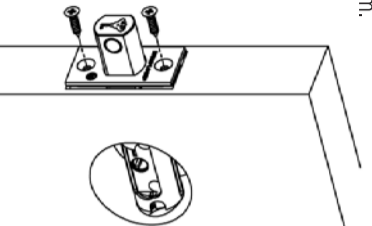

4 Install bolt (Drive-in type)

- Install bolt as shown in diagram.
- Carefully tap the bolt into position (flush with door).

Note: Do not tap on the bolt directly. Use a soft piece of wood as a divider.

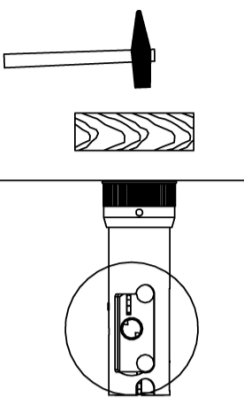

- 3- Relocate the arm's position to the other socket at the edge of the bolt.

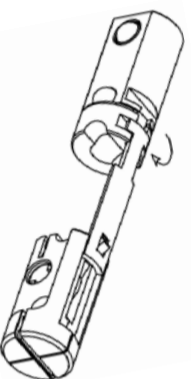

- 4- Carefully slide the mechanism back through the back side of the bolt housing until the pin pops up in the first locating hole.

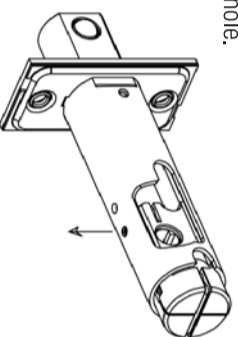

HERCULAR®

Drive-in conversion instructions

- 1- Pop off the faceplate with a flat screwdriver in the recessed areas.

- 4- Tighten the two socket screws with an Allen Wrench/Hex. Key.

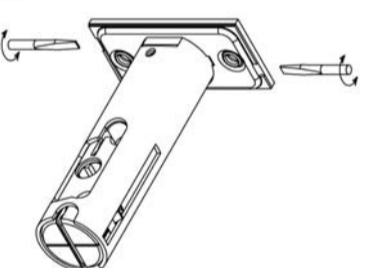

- 2- Remove the front plate.
 - Disengage the spring clip for removal of the back plate.

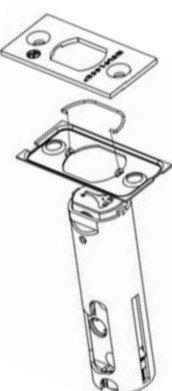

- 3- Slide the drive-in crown into position and align the holes on the crown to the ones on the bolt housing.



HERCULAR®

Installation Instructions

- 1 **Mark Door**
 - Position template at proper height on the door.
 - Mark center for 2 1/8" (54mm) hole according to required backset.
 - Mark center of bolt hole according to door thickness.

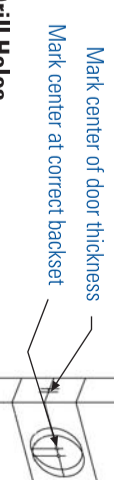

2 Drill Holes

- Drill a 2 1/8" (54mm) through hole on face of door.
- Drill 1" (25mm) hole (if utilizing the bolt with faceplate) or a 1 1/8" (28mm) hole (drive-in bolt) to a depth of 3 3/4" (95mm).
- Recess for bolt faceplate, if necessary.

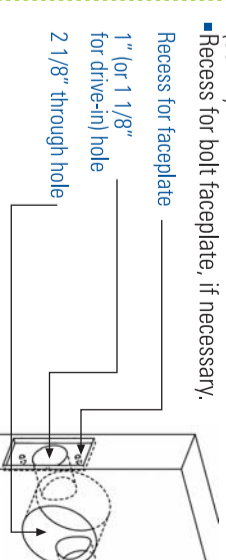

5

- If the deadbolt does not function smoothly, the assemblies are binding. Disassemble and adjust the tailpieces accordingly for proper function.
- Slide on cover plate.

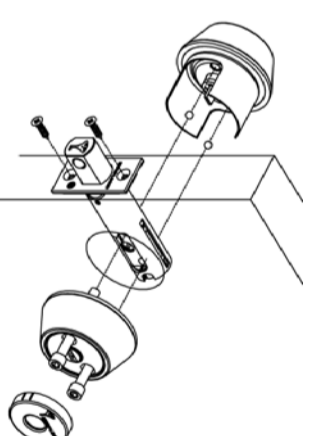

4

Vertical installation

Horizontal installation

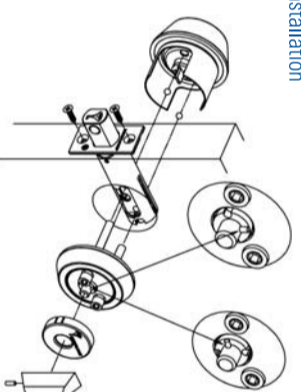

6 Install Body (Double Cylinder)

- Throw the bolt to the locked position.
- Remove the cover plate on inside body assembly to expose two bolt holes.
- Place the ball bearings in the bolt holes on the outer body assembly.
- Slide the outer body assembly into the door making sure the tailpiece engages the bolt correctly and does not protrude further than halfway through the width of the bolt.
- If the tailpieces are too long due to the thickness of the door, the tailpieces can be shortened by removing the assembly and cutting it to the correct length.
- The same can be done with internal body assembly.
- Once tailpieces are the correct length, position inside assembly on the door making sure the tailpiece engages the bolt correctly.
- Insert Hex bolts and tighten.
- Check operation.

3

Vertical installation

Horizontal installation

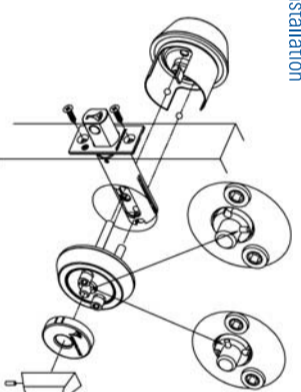

6 Install Body (Double Cylinder)

- Throw the bolt to the locked position.
- Remove the cover plate on inside body assembly to expose two bolt holes.
- Place the ball bearings in the bolt holes on the outer body assembly.
- Slide the outer body assembly into the door making sure the tailpiece engages the bolt correctly and does not protrude further than halfway through the width of the bolt.
- If the tailpieces are too long due to the thickness of the door, the tailpieces can be shortened by removing the assembly and cutting it to the correct length.
- The same can be done with internal body assembly.
- Once tailpieces are the correct length, position inside assembly on the door making sure the tailpiece engages the bolt correctly.
- Insert Hex bolts and tighten.
- Check operation.

3

Vertical installation

Horizontal installation

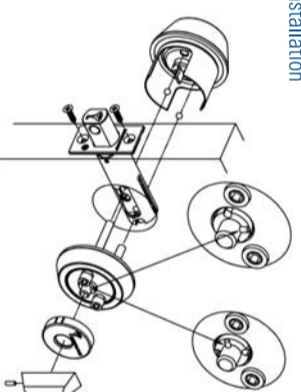

6 Install Body (Double Cylinder)

- Throw the bolt to the locked position.
- Remove the cover plate on inside body assembly to expose two bolt holes.
- Place the ball bearings in the bolt holes on the outer body assembly.
- Slide the outer body assembly into the door making sure the tailpiece engages the bolt correctly and does not protrude further than halfway through the width of the bolt.
- If the tailpieces are too long due to the thickness of the door, the tailpieces can be shortened by removing the assembly and cutting it to the correct length.
- The same can be done with internal body assembly.
- Once tailpieces are the correct length, position inside assembly on the door making sure the tailpiece engages the bolt correctly.
- Insert Hex bolts and tighten.
- Check operation.

4

Vertical installation

Horizontal installation

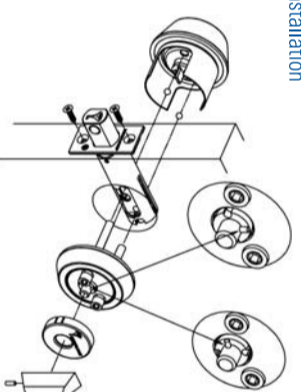

6 Install Body (Double Cylinder)

- Throw the bolt to the locked position.
- Remove the cover plate on inside body assembly to expose two bolt holes.
- Place the ball bearings in the bolt holes on the outer body assembly.
- Slide the outer body assembly into the door making sure the tailpiece engages the bolt correctly and does not protrude further than halfway through the width of the bolt.
- If the tailpieces are too long due to the thickness of the door, the tailpieces can be shortened by removing the assembly and cutting it to the correct length.
- The same can be done with internal body assembly.
- Once tailpieces are the correct length, position inside assembly on the door making sure the tailpiece engages the bolt correctly.
- Insert Hex bolts and tighten.
- Check operation.

5

- If the deadbolt does not function smoothly, the assemblies are binding. Disassemble and adjust the tailpieces accordingly for proper function.
- Slide on cover plate.

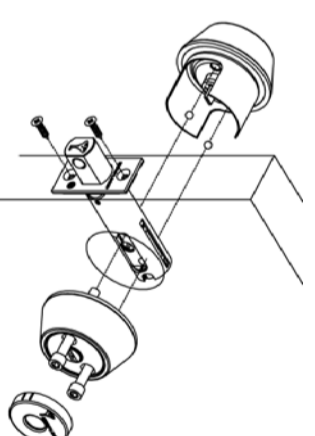

8 Install strike

- Position the strike box in the frame.
- Drill two 1/8" (3mm) pilot holes for long screws in back of the box.
- When prepping the hole locations for strike box, the holes for the long screws should be positioned towards exterior for better security.
- Install the short screws at top and bottom of the strike box.
- Install the long screws.
- Remove the short screws.
- Install the strike plate in position and tighten the screws.

